

Female connector
– Contact spacing
2.54 and 5.08 mm –

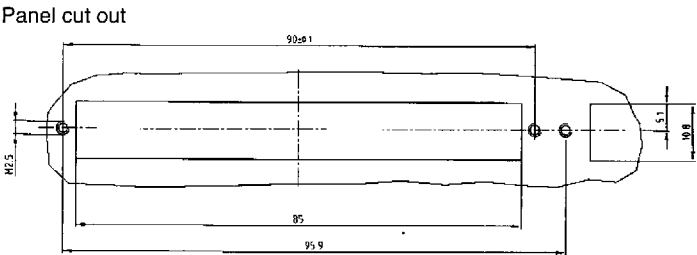

Kinds of contacts

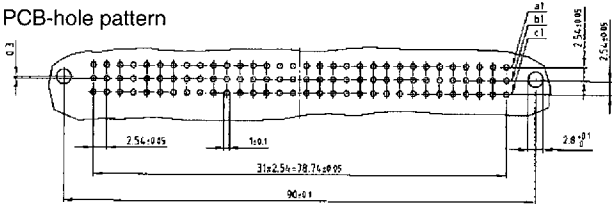
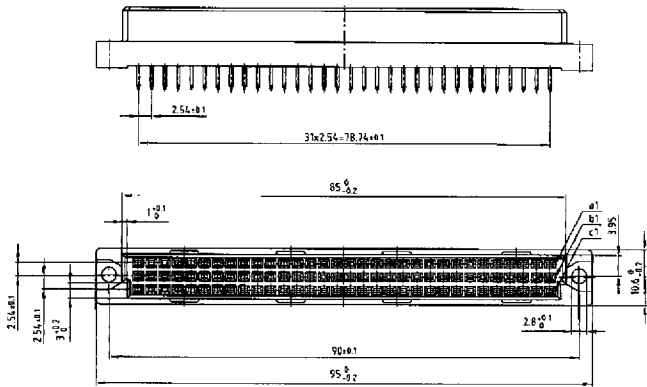
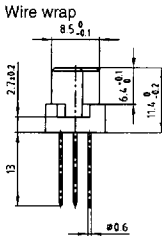

Solder pin 2.5 mm

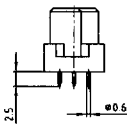

Solder pin 4 mm

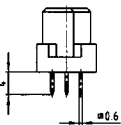

Solder lug

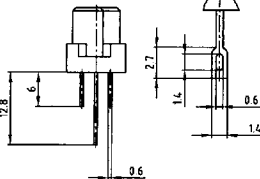

angled

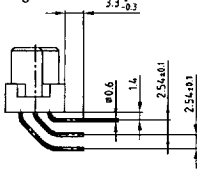

Solder pin 2.5 mm with clip

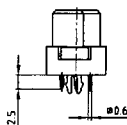

Part numbers

| | | Female connector – Contact spacing 2.54 and 5.08 mm | | | | | |
|-------------|---------|---|-----------------------------------|-----------------------------------|---------------------------------|---------------------------------|-------------------------------------|
| No. of Pos. | Version | Wire wrap | Solder pin 2.5 mm | Solder pin 4 mm | Solder lug | angled | Solder pin with clip |
| 32 | | C 32 F3 WW a 122 A 10169 X | C 32 F3 P2 a 122 A 10219 X | C 32 F3 P4 a 122 A 10269 X | C 32 F3 La 122 A 10319 X | C 32 F3 Aa 122 A 10369 X | C 32 F3 PC 2 a 122 A 13249 X |
| 32 | | C 32 F3 WW a+c 122 A 10179 X | C 32 F3 P2 a+c 122 A 10229 X | C 32 F3 P4 a+c 122 A 10279 X | C 32 F3 La+c 122 A 10329 X | C 32 F3 Aa+c 122 A 10379 X | C 32 F3 PC 2 a+c 122 A 13259 X |
| 64 | | C 64 F3 WW a+b 122 A 10189 X | C 64 F3 P2 a+b 122 A 10239 X | C 64 F3 P4 a+b 122 A 10289 X | C 64 F3 La+b 122 A 10339 X | C 64 F3 Aa+b 122 A 10389 X | C 64 F3 PC 2 a+b 122 A 13269 X |
| 64 | | C 64 F3 WW a+c 122 A 10199 X | C 64 F3 P2 a+c 122 A 10249 X | C 64 F3 P4 a+c 122 A 10299 X | C 64 F3 La+c 122 A 10349 X | C 64 F3 Aa+c 122 A 10399 X | C 64 F3 PC 2 a+c 122 A 13279 X |
| 96 | | C 96 F3 WW a+b+c 122 A 10209 X | C 96 F3 P2 a+b+c 122 A 10259 X | C 96 F3 P4 a+b+c 122 A 10309 X | C 96 F3 La+b+c 122 A 10359 X | C 96 F3 Aa+b+c 122 A 10409 X | C 96 F3 PC 2 a+b+c 122 A 13289 X |

Part Number

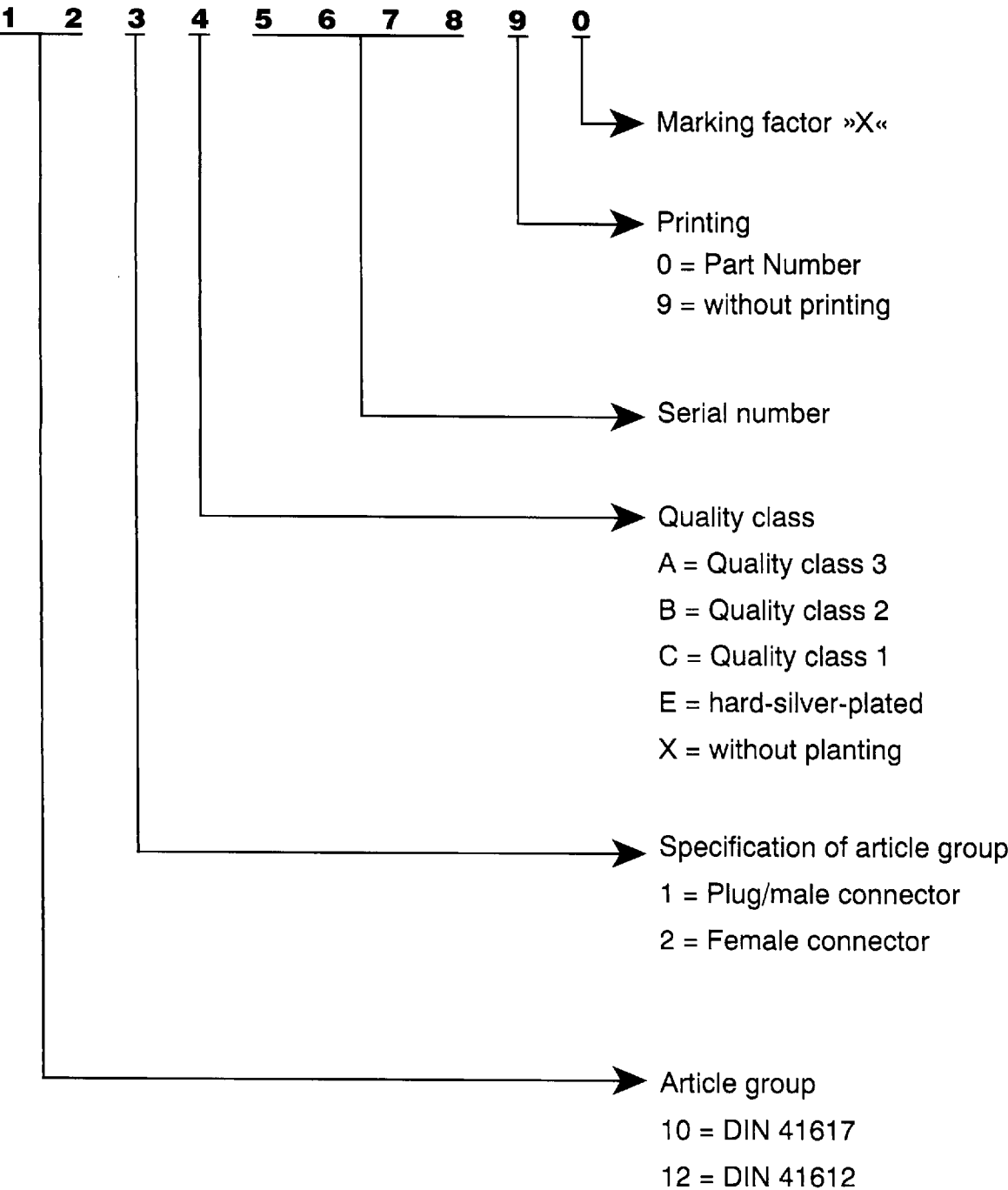

Order example

| Male connector type C 64 pos. angled solder pin without printing | | | |
|--|--|------------------|---------------|
| Quality class | | Part Number | |
| 3 | | C 64 M 3 A a + c | 121 A 10139 X |
| 2 | | C 64 M 2 A a + c | 121 B 10139 X |
| 1 | | C 64 M 1 A a + c | 121 C 10139 X |

| Technical Data | | DIN 41617 | DIN 41617/41612 | Type B | Type B/2 | Type C | Type C/2 | Type M |
|---------------------------------|------------------------------|------------------------|----------------------|----------------------|----------------------|----------------------|----------------------|--|
| Initial contact resistance | | ≤ 15 mΩ | ≤ 10 mΩ | ≤ 20 mΩ | ≤ 20 mΩ | ≤ 20 mΩ | ≤ 20 mΩ | ≤ 20 mΩ |
| Initial insulation resistance | QUAL. CL 1 | ≥ 10 ¹² Ω | ≥ 10 ¹¹ Ω | ≥ 10 ¹² Ω | ≥ 10 ¹² Ω | ≥ 10 ¹² Ω | ≥ 10 ¹² Ω | ≥ 10 ¹² Ω |
| | QUAL. CL 2 | ≥ 10 ¹¹ Ω | | ≥ 10 ¹² Ω | ≥ 10 ¹² Ω | ≥ 10 ¹² Ω | ≥ 10 ¹² Ω | ≥ 10 ¹² Ω |
| | QUAL. CL 3 | ≥ 10 ¹⁰ Ω | | ≥ 10 ¹¹ Ω | ≥ 10 ¹¹ Ω | ≥ 10 ¹¹ Ω | ≥ 10 ¹¹ Ω | ≥ 10 ¹¹ Ω |
| Clearance distance | Contact/ground | ≥ 1 mm | ≥ 1,2 mm | | | | | |
| | Contact/contact | ≥ 0,5 mm | | ≥ 1,2 mm | ≥ 1,2 mm | ≥ 1,2 mm | ≥ 1,2 mm | ≥ 1,2 mm |
| Creepage distance | Contact/ground | ≥ 1 mm | ≥ 1,2 mm | | | | | |
| | Contact/contact | ≥ 1,0 mm | | ≥ 1,2 mm | ≥ 1,2 mm | ≥ 1,2 mm | ≥ 1,2 mm | ≥ 1,2 mm |
| Test voltage V r.m.s. | Contact/ground | 900 V | 1000 V | 1000 V | 1000 V | 1000 V | 1000 V | 1000 V |
| | Contact/contact | 1150 V | 1550 V | 1550 V | 1550 V | 1550 V | 1550 V | 1550 V |
| Working voltage* | | 250 V | 250 V | 250 V | 250 V | 250 V | 250 V | 250 V |
| Insulation group* | | A | A | A | A | A | A | A |
| Working current ** | + 20° C | GT 1+2 = 4 A max. | 4 A max. | 2 A | 2 A | 2 A | 2 A | 2 A |
| | + 70° C | | | 1 A | 1 A | 1 A | 1 A | 1 A |
| | + 100° C | GT 3 = 2 A max. | | 0,5 A | 0,5 A | 0,5 A | 0,5 A | 0,5 A |
| Operating temperature | Quality cl. I | -65° ... + 125° C | -65° ... + 125° C | -55° C | -55° C | -55° C | -55° C | -55° C |
| | Quality cl. II | -55° ... + 125° C | | ... | ... | ... | ... | ... |
| | Quality cl. III | -25° ... + 85° C | | +125° C | +125° C | +125° C | +125° C | +125° C |
| Moulding material | PC = Polycarbonat | X | X | | | | | |
| | PBTP = Polyester | | | X | X | X | X | X |
| | PA = Polyamid | | | | | | | |
| Contact material | | | | | | | | |
| Coding system | with coding | | | X | X | X | X | X |
| | without coding | X | X | | | | | |
| Flammability | PC = Polycarbonat | UL 94 V-1 | | | | | | |
| | PBTP = Polyester | UL 94 V-0 | | | | | | |
| | PA = Polyamid | UL 94 H-B | | | | | | |
| Insertion and withdrawal forces | F max. | 13p. 32 N/AU • 30 N/AG | | 32p 30N | 16p 15N | 32p 30N | 16p 15N | 78+2p 90 52+2p 75 60+4p 85 40+4p 70 42+6p 85 28+6p 70 24+8p 80 |
| | F max. | 21p. 33 N/AU • 48 N/AG | | 64p 60N | 32p 30N | 64p 60N | 32p 30N | |
| | F max. | 31p. 48 N/AU • 70 N/AG | 31+1p 80N | | | 96p 90N | 48p 45N | |
| Life | Quality class 1 ≥ 500 cycles | X | X | X | X | X | X | X |
| | Quality class 2 ≥ 400 cycles | X | | X | X | X | X | X |
| | Quality class 3 ≥ 50 cycles | X | | X | X | X | X | X |
| | AG | X | | | | | | |

Mouser Electronics

Authorized Distributor

Click to View Pricing, Inventory, Delivery & Lifecycle Information:

[Amphenol:](#)

[122A10329X](#) [122A10349X](#) [122A10319X](#)